

● Symbols used throughout the instruction manual, comprise:



Cut off shaded portion.



5mm
Drill holes with
the specified diameter.



Pay close attention here!



Must be purchased
separately.



Assemble left and right sides
the same way.

PARTS

PLASTIC PARTS ----- X1
PC PARTS ----- X2
DECORATIVE DECAL SHEET ----- X2

PARTS BAG

TAPPING SCREW ----- X5
METAL STAY BAR ----- X2
MAGNET ----- X2
PC MAGNET COVER ----- X2
3M DOUBLE-SIDED TAPE ----- X2

PLASTIC PARTS

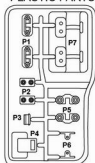

PC PARTS

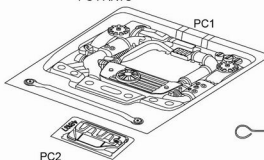

PC3



Here just take NO.48197 as an example, all the installation methods of
NO.48191/48192/48193/48194/48195/48196/48246/48247 are same with NO.48197.

1 Painting

PC1 PC2

① Before painting, use a neutral detergent to
remove any oil residues and dirt.



② Paint the engine from the inside.

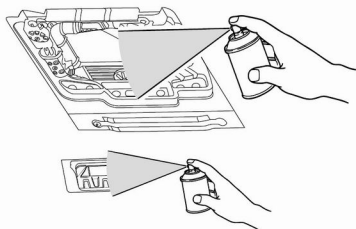

2 Cut the Car Body

Here just take one body shell as an example,
all the installation methods are same.

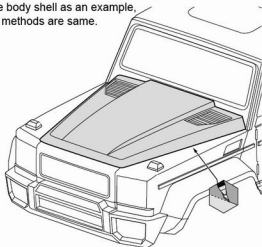

3 Measuring

⚠ Before cutting the engine, please take
a caliper to measure the actual size.

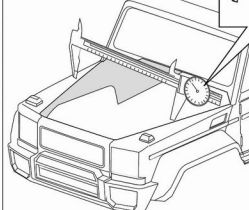
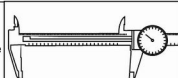

4 Cutting

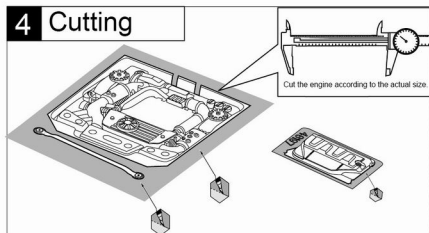

Remove the protective film from the PC parts.

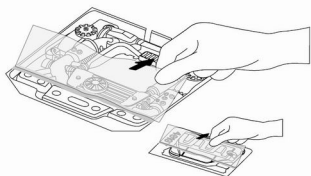

5 Decal

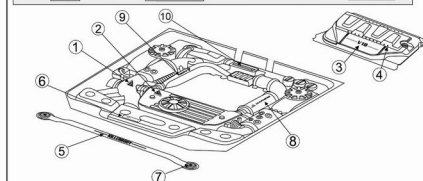

Engine cover assembly.

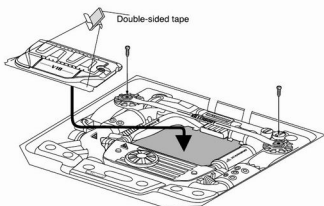

6 Assembling

1 Assemble the cutted engine bonnet to body shell.

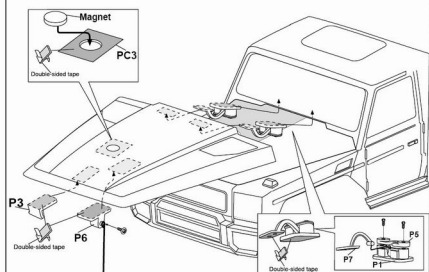

2 Assemble the engine to body shell.

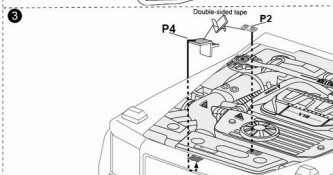

7 Finished

