

PARTS

PLASTIC PARTS

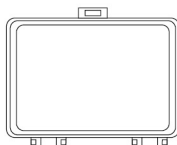

P1

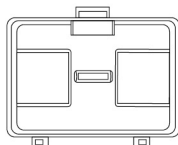

P2



P3



ROLLER BAR — X3

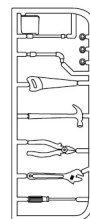

1 Painting

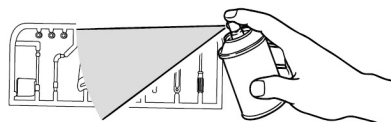
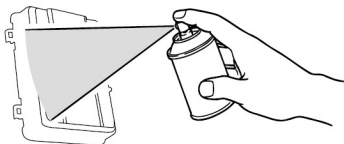

After painting, please paint the tool details with the fine point brushes.

2 Assembling

Fixing the lock catch by hand.

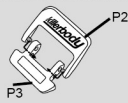

Lock catch 2 for option.

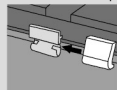

Insert the lock catch as the arrow shown.

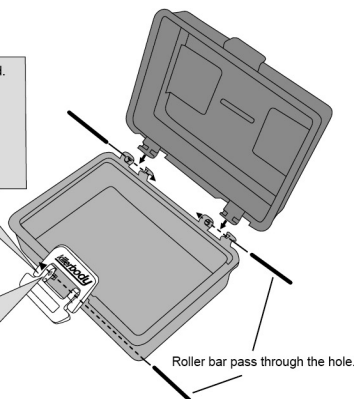

Roller bar pass through the hole.

Fixing the handle by hand.

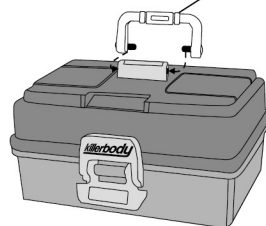

3 Finished

